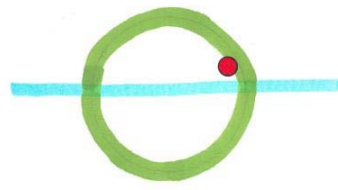


catalyst @ botanic spine

botanic spine

an eco corridor for Dublin city



Catalyst @ Botanic Spine

THE BOTANIC SPINE: an 18 km long orbital linear park that threads through a series of pocket parks; some existing, some proposed. Sheriff Street Park is one such park who's radical redesign acts as a catalyst for the area.

The Spine acts as an eco corridor and greenway that threads together the 6 existing city waterways, the Phoenix Park (Europe's largest city park) and the Botanic Gardens, which serves as the brain of the network that uses the spine as a constant feedback loop to output ecological projects and thinking into the wider city. The Botanic Gardens become the Dublin node in a global ecological system, greening the city, improving plant and animal life along green corridors, raising awareness and getting citizens involved with exciting eco initiatives.

The Spine is also a CPUL (continuous productive urban landscape) with a series of organic food gardens along it

The Spine mimics somewhat the structure and function of the human spine: a network of different systems flowing through the spine; plant and animal life, people, water, cycle route, metro line, digital info, hurling fans heading up to Croker for the big game?

CATALYST @ botanic spine

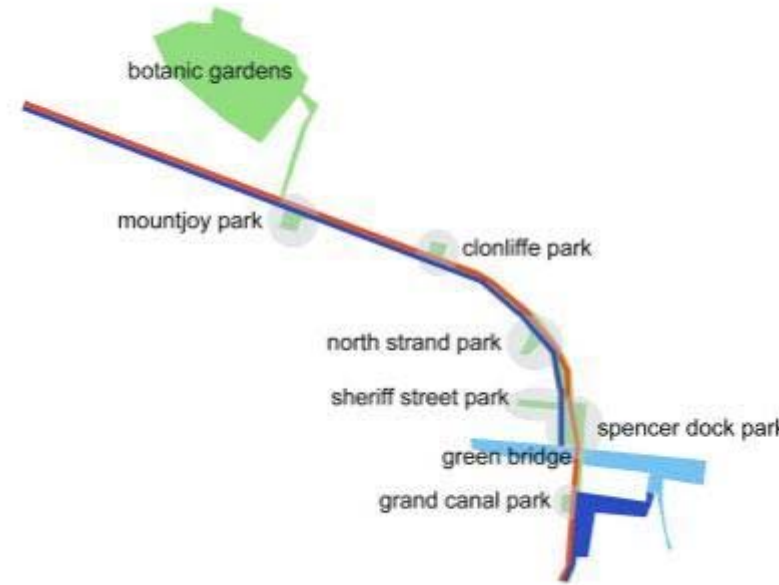
2005 thesis available:
DIT Bolton Street library
An Taisce
Duncan Crowley, architect
fusp@yaho.co.uk
Phone: 00-353-1-8307767

Links:

- Botanic spine
- That eco city idea is starting to take off in china
- Greening city, connecting communities update:



18km ecological corridor for city



spine threads through series of city parks, connecting the city



spine as urban regenerator

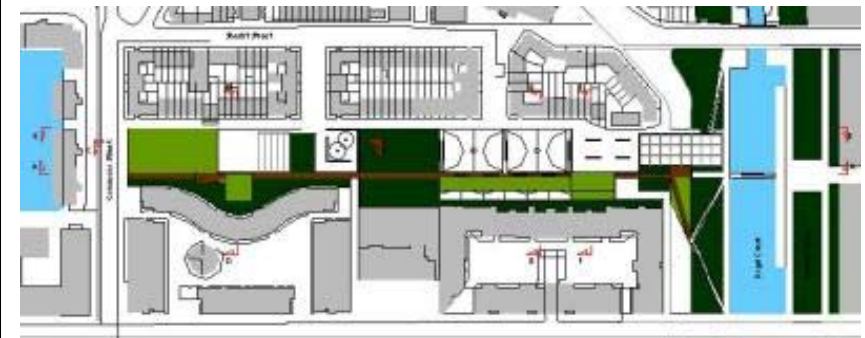


A network of different systems flowing through the spine; plant and animal life, people, water, cycle route, metro line, digital info, Hurling fans heading up to Croker for the big game?

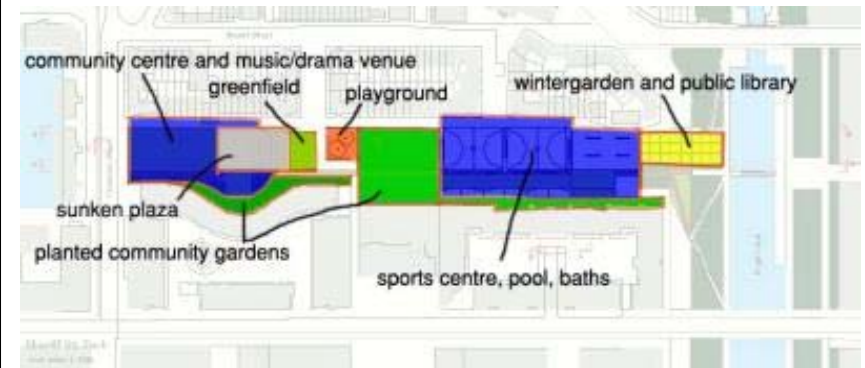


figure ground 2008

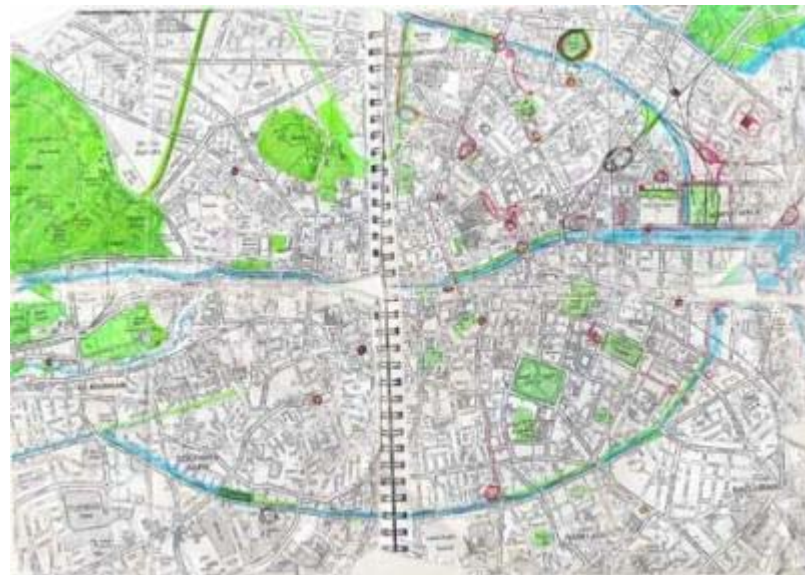
Sheriff Street park, royal canal park and Liffey park, green bridge



Sheriff Street park : stuff to do : catalyst for community interaction



concept = stuff to do



Dublin's green and blue spaces